



**LIAN LI**

Feel the difference

---

# O11 DYNAMIC

**Installation Guide / 安裝說明書**  
**Guide d'installation / Montageanleitung**  
**Guía de instalación / インストールガイド**

- \* Case components    \* Composants du boîtier    \* Guía de instalación  
 \* 機殻部品紹介        \* Gehäusekomponenten    \* ケース各部紹介

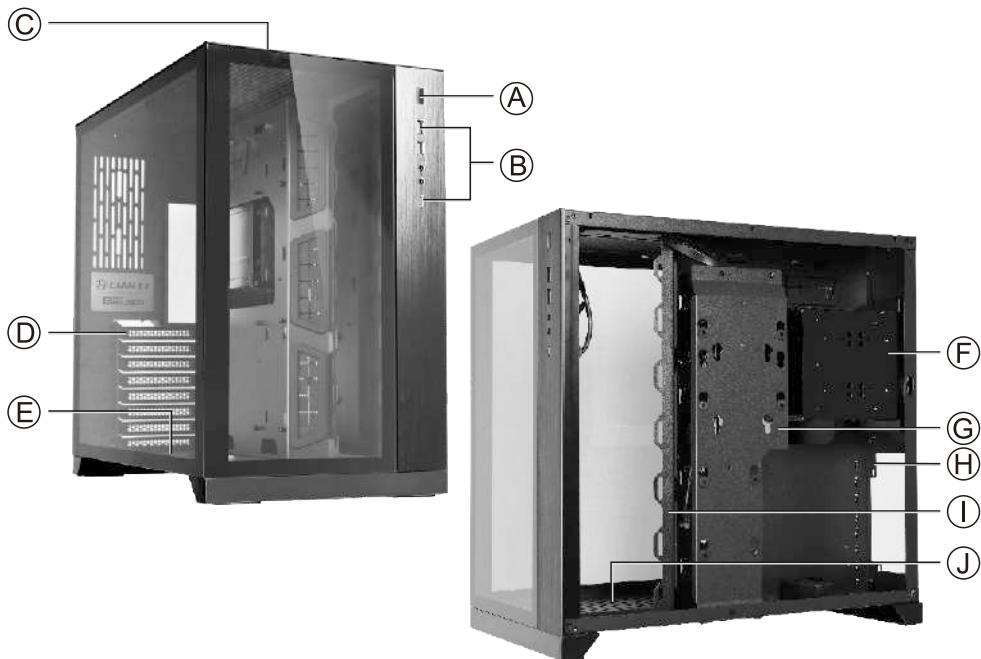

- (A) Power switch / 電源開關按鈕 / 電源スイッチ  

---

 (B) Multi-media ports (USB 3.0 x 2, USB 3.1 Type-C, HD audio) / 多媒體連接埠 / マルチメディアI/Oポート  

---

 (C) Spare 120 mm fans x 3 or 140 mm fans x 2 / 預留 120 mm風扇 x 3 或 140 mm 風扇 x 2  
 追加120 mm ファン x 3 または140 mm ファン x 2  

---

 (D) PCI slots with ventilation / PCI 通風擋片 / 通気構造のPCIスロット  

---

 (E) 2.5" HDD x 2 / 2.5吋硬碟 x 2 / 2.5" HDDマウントスペース x 2  

---

 (F) Removable HDD tray ( 3.5" HDD x 2 or 2.5" HDD x 2 or PSU x 1 ) / 可拆硬碟托盤 / リムーバブルHDDトレイ  

---

 (G) Removable HDD tray ( 3.5" HDD x 1 + 2.5" HDD x 1 or 2.5" HDD x 2 ) /  
 可拆硬碟托盤 / リムーバブルHDDトレイ  

---

 (H) PSU tray / 電源供應器裝置槽 / 電源ユニット固定ステー  

---

 (I) Spare 120 mm fans x 3 / 預留 120 mm 風扇 x 3 / 追加120 mm ファン x 3  



---

 (J) Spare 120 mm fans x 3 / 預留 120 mm 風扇 x 3 / 追加120 mm ファン x 3

**\* Hardware list**  
**\* 零件盒部品一覽表**

**\* Liste des pièces**  
**\* Hardwareliste**

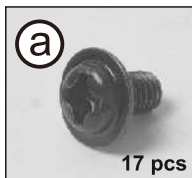
**\* Lista de materiales**  
**\* 付属品一覽**



Screws for mother board & 2.5" HDD mount

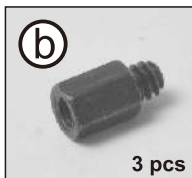

Stand off bolt (Spare parts) for Motherboard Mount

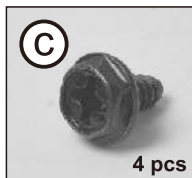

Screws for PSU Mounting

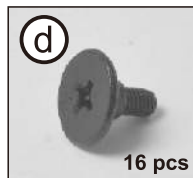

Screws for 2.5" HDD

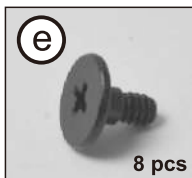

Screws for 3.5" HDD

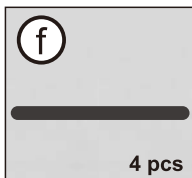

Velcro for cable management

※ Exceeded quantity are spare parts.  
 ※ 多餘的零件數量是備品。  
 ※ Les pièces supplémentaires sont des pièces de rechange.  
 ※ Zusätzliche Teile können als Ersatzteile verwendet werden.  
 ※ Exceeded quantity are spare parts.  
 ※ ネジには予備が含まれてれています。

- \* Remove top panel**
- \* 卸下頂部面板**
- \* Retirer le panneau supérieur**
- \* Entfernen Sie die obere Abdeckung**
- \* Retire el panel superior**
- \* トップパネルを取り外す**

- \* Remove side panel**
- \* 卸下側板**
- \* Retirer le panneau latéral**
- \* Seitenverkleidung entfernen**
- \* Retire el panel lateral**
- \* サイドパネルを取り外す**

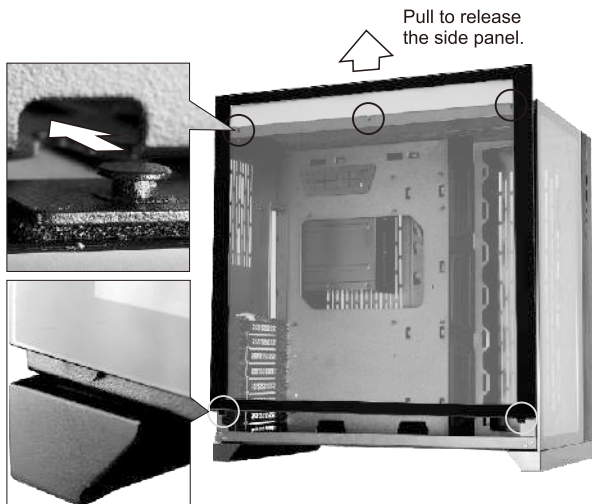

- \* PSU installation
- \* 電源供應器安裝
- \* Installation du plateau du bloc d'alimentation

- \* PSU-Einsatz installieren
- \* Instalación de la fuente de alimentación
- \* 電源ユニットの取り付け

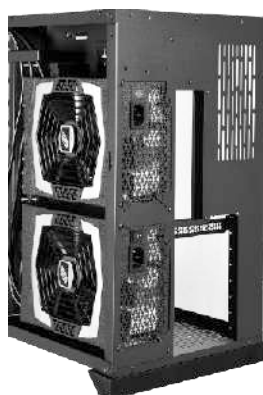
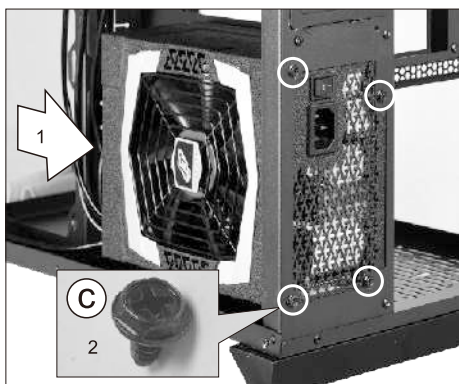
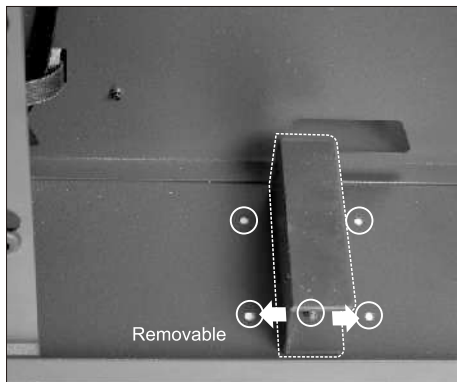
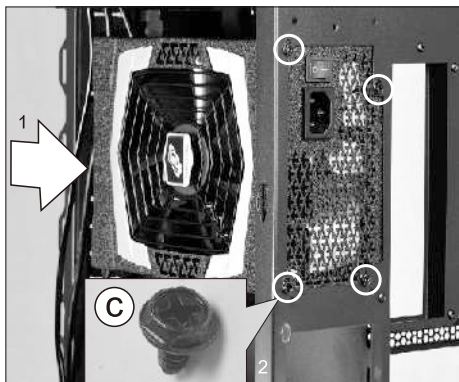
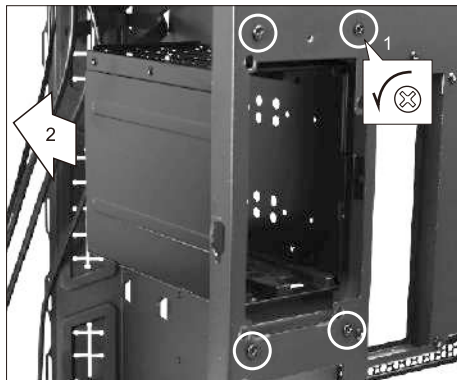
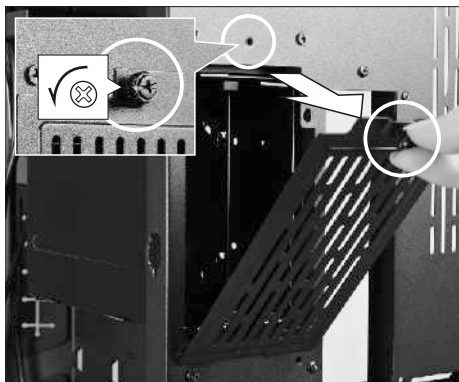

- \* Motherboard installation
- \* 主機板安裝
- \* Installation de la carte mère
- \* Motherboard installieren
- \* Instalación de la placa base
- \* マザーボードの取り付け

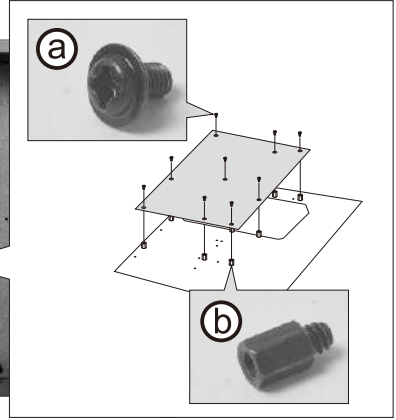
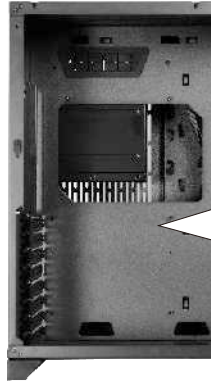

- \* 2.5"/3.5" HDD installation
- \* 2.5/3.5吋硬碟安裝
- \* Installation d'un DD 2.5"/3.5"

- \* 2.5/3.5-Zoll-Festplatte installieren
- \* Instalación de unidad de disco duro de 2.5"/3.5"
- \* 2.5"/3.5" ハードディスクの取り付け

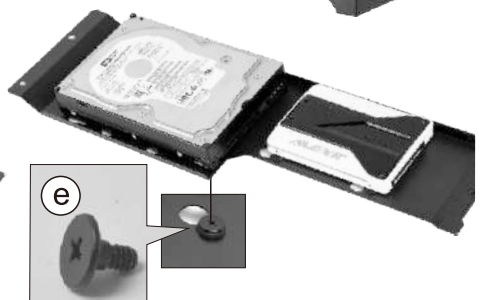
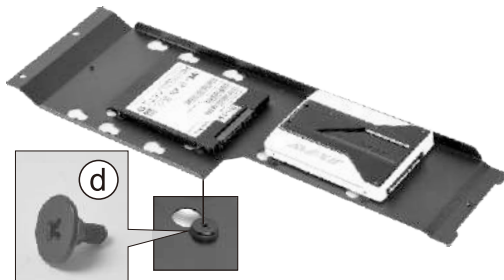
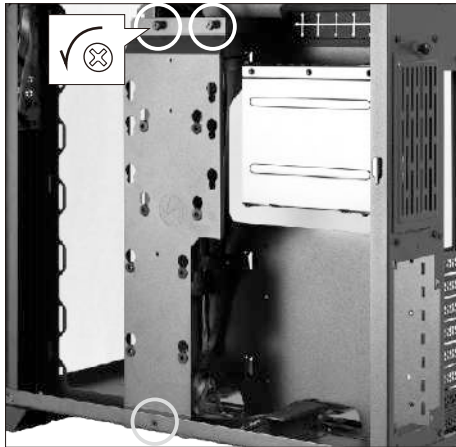

- \* 2.5"/3.5" HDD installation
- \* 2.5/3.5吋硬碟安裝
- \* Installation d'un DD 2.5"/3.5"

- \* 2.5/3.5-Zoll-Festplatte installieren
- \* Instalación de unidad de disco duro de 2.5"/3.5"
- \* 2.5"/3.5" ハードディスクの取り付け

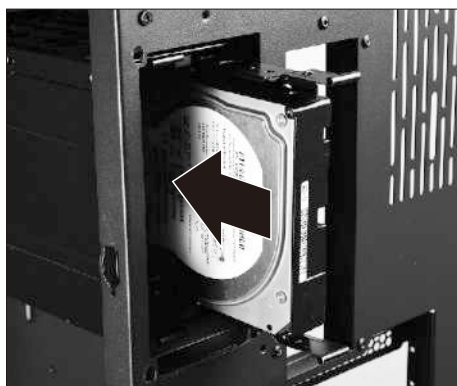
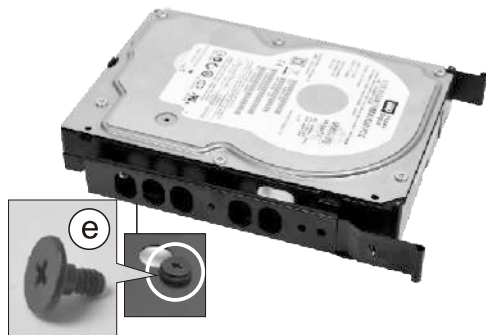
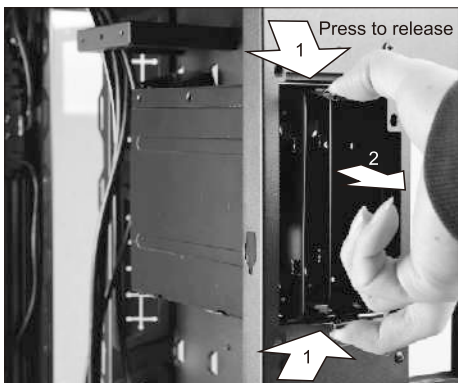
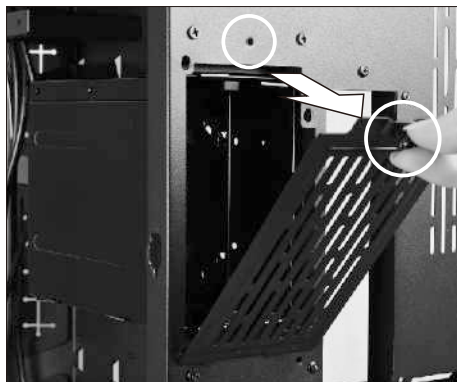
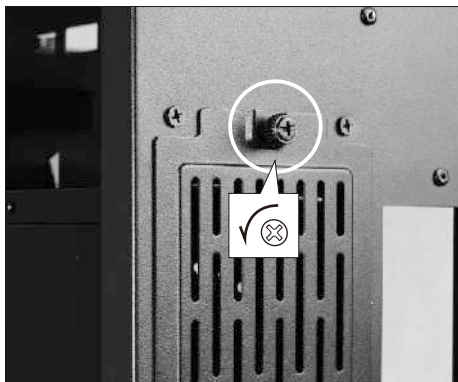

- \* 2.5" HDD installation
- \* 2.5吋硬碟安裝
- \* Installation d'un DD 2.5"
- \* 2.5-Zoll-Festplatte installieren
- \* Instalación de unidad de disco duro de 2.5"
- \* 2.5"ハードディスクの取り付け

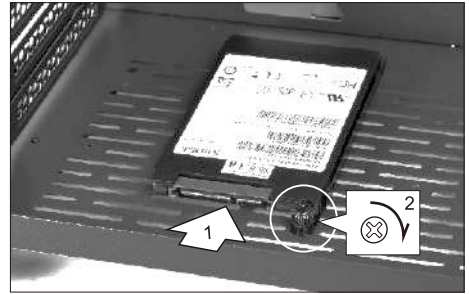
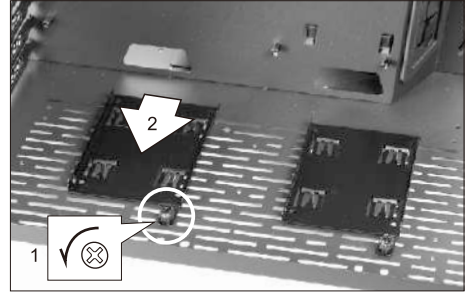
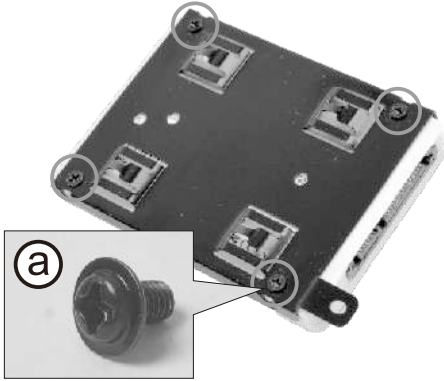

- \* Remove air filters
- \* 空氣濾網拆卸
- \* Retirez les filtres à air
- \* Entfernen Sie Luftfilter
- \* Retire los filtros de aire
- \* エアフィルターの取り外し

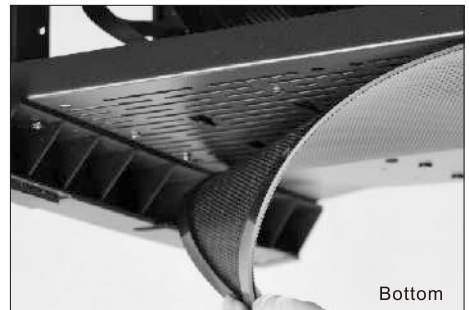
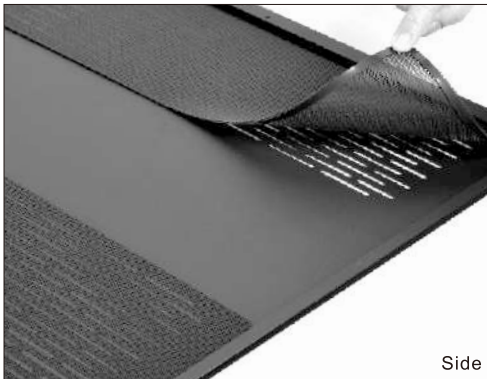
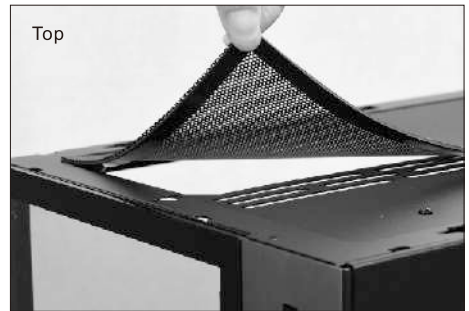

\* Hardware clearance

\* 硬體擴充支援

- CPU air cooler
- GPU
- PSU with bracket
- PSU without bracket
- Radiator clearance

\* Passage de matériel

\* Hardware-Freigabe

\* Limpieza de hardware

\* ハードウェア拡張のサポート

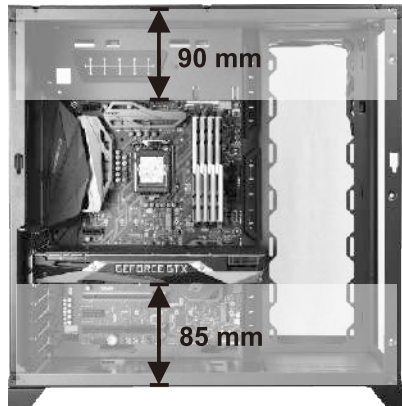
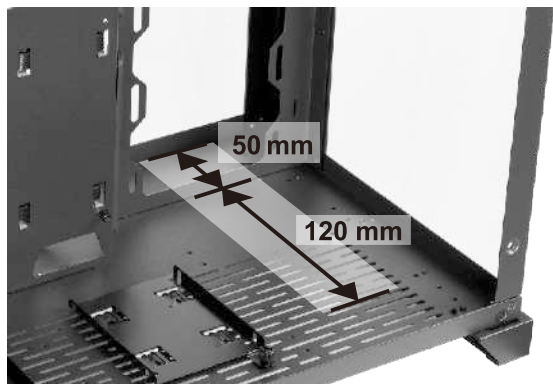
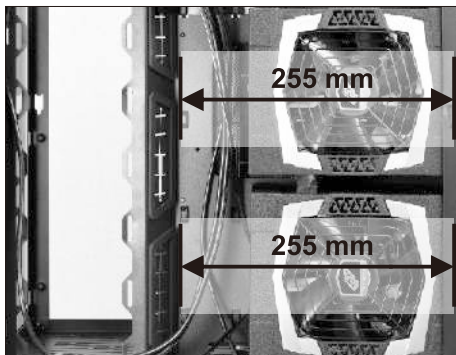
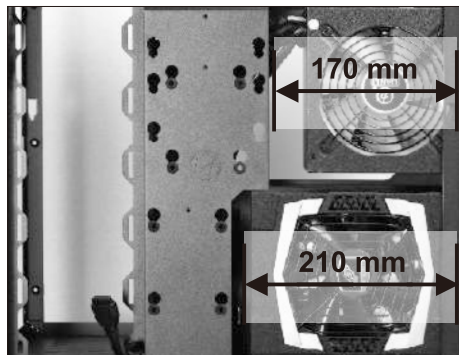
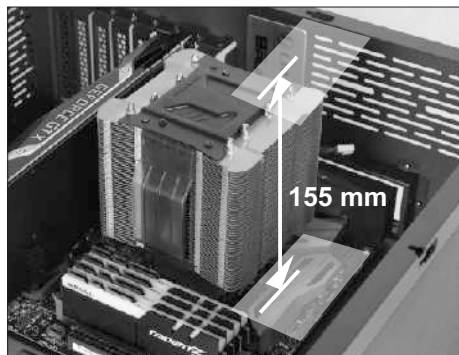



**Option kits / 選配套件**  
**Kits optionnels / Optionale Sets**  
**Kits opcionales / オプションパーツ**

Upright display card Kits  
 (200 mm PCI-e Express 16X Riser Card Adapter  
 Extender Cable Kit)

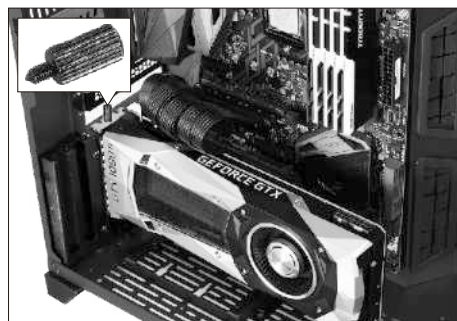
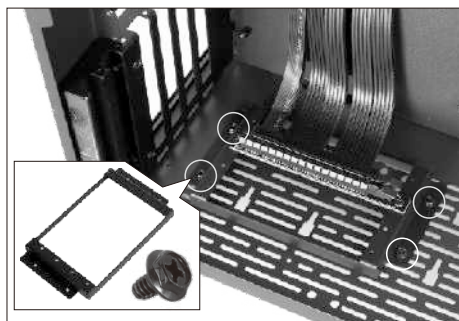
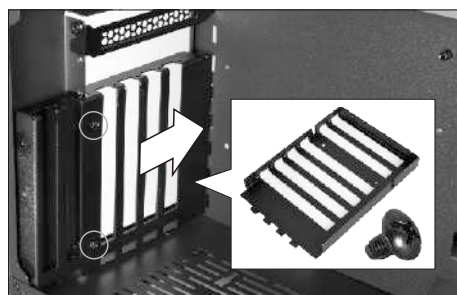
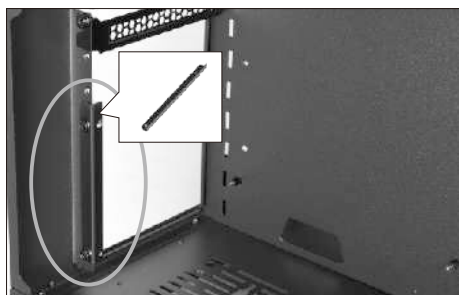
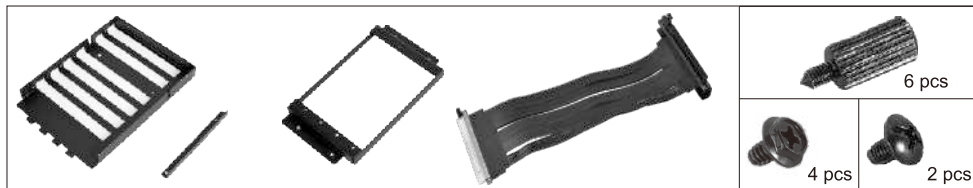

- \* I/O port installation
- \* USB 3.0 / HD Audio 接続定義
- \* Installation du port E/S
- \* I/O-Port installieren
- \* Instalación de los puertos de E/S
- \* I/O ポートに関して

**USB 3.0** Supports motherboard  
 USB 3.0 20 Pin header

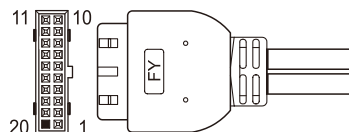

**HD AUDIO**

- |              |    |   |               |
|--------------|----|---|---------------|
| Blue         | 10 | 9 | Green         |
| Black purple | 8  | 7 | Key           |
| Yellow       | 6  | 5 | Orange        |
| Gray         | 4  | 3 | N.C.          |
| Red          | 2  | 1 | GND+H.S. TUBE |

